

The University Lyon 1 provides its instructors and students with tools for creating and disseminating innovative educational resources, to communicate, to collaborate, to grade

# Suite connect

## Spiral Connect

**Spiral Connect**, the new educational platform of the Université Claude Bernard Lyon 1, is designed for collaboration and social networking functionality.

**Spiral Connect** puts the focus of the learning activity on the individual, enabling each student to make connections between their courses and networks open to the outside world.

## Eval connect

**Eval Connect** is a online tool enabling institutions to efficiently manage student course evaluations, including creating personalised questionnaires, administering access rights and displaying real-time statistics.

## More reliable tools, richer interfaces

Based on the Flex / Java tools nexus, the Connect Suite has a robust architecture, rich interfaces and advanced graphics which allow us to move towards greater compatibility with mobile devices and even off-line use. Java technology, having stood the test of years in many complex applications, offers the additional advantage of being OpenSource, thus permitting us to open the Connect Suite to a community of develo-



### Compatible Tools for a Wider Audience.

As Adobe Flash Player is installed on more than 90% of personal computers, the Connect Suite is ideally suited for use on operating systems and browsers.

### Single Log-in

The ability to interconnect the databases of each platform provides a single authentication for each user.

**Simplified Management of Objects and Files :** With the graphical interface, use the ergonomic 'drag and drop' to rapidly create, move or duplicate files

and objects. Or flip to the text-based interface for traditional menus (copy, paste, duplicate, delete, rename, move ...)

**Integrated Messaging Tools :** real-time chat, email, receive alerts and get follow-up messages.

**Multi-language System :** automatic detection or assign default language



## Spiral Connect

### A social network learning platform

**Spiral Connect** is the new learning management system of the Université Claude Bernard Lyon 1 designed for collaborative work and social networking functionality.

**Spiral Connect** puts the focus of each learning activity on the individual allowing students to construct their own learning path, through the use of novel tools on the platform and the possibility to make connections with networks open to the outside world.

### New tools to effectively create, broadcast and communicate

**Innovative video applications :** the new player (with an integrated chaptering system ) allows users to create movies and to rapidly incorporate comments with ease.

**An interactive whiteboard :** Enables users to communicate visually in real time.

**A personalized work environment :** with content management by folder or tree, and a customizable view (colours, images and more ...).

**A bibliography and a database of links :** to retrieve the online properties of a document (description, keywords, images ...) and to validate links.

**Simplified object and file management :** no longer constrained by file size or number. Spiral Connect now offers the opportunity to select one or more files to transfer, to download a document while preserving its properties, and to organize files as you wish.

**A common interface for teachers and students :** where the rights assigned to each user determines the control and access of objects.

**A powerful search engine** to rapidly find and access information by keyword.

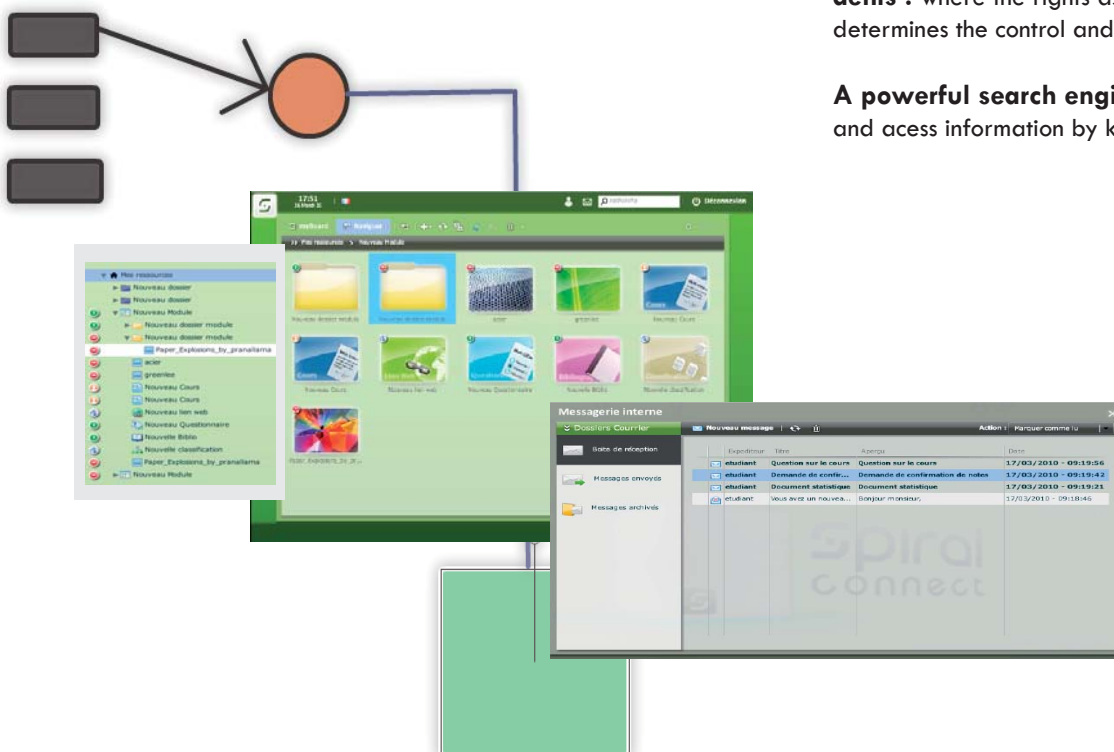



## Eval Connect

**Eval Connect** is a online tool enabling institutions to efficiently manage student course evaluations, including creating personalised questionnaires, administering access rights and displaying real-time statistics.

### Create, plan and manage assessments campaigns in real time

#### Planning and managing evaluations

The evaluation portal allows you to design, plan and monitor evaluations projects in real-time : definition of courses to be evaluated, creation and broadcast of standard questionnaires, definition of opening and closing dates of questionnaires, e-mailing to inform students of the opening of the questionnaires, and automatic reminders.

#### Registration management

Automatically loads course calendar from the institutional databases and simplifies registration of students and teachers in their courses. Possibility to include other teachers as stakeholders for a specific course.

#### Creation and distribution of questionnaires

The «create questionnaire» tool allows you to design questions with single choices, multiple choices, matrix (tables of questions) and open response. You can define the number of questions that will be displayed per screen, make a specific question obligatory and organize the questionnaire. A simple click publishes the questionnaires to the concerned students.

#### Presentation data analysis

Results can be displayed graphically question by question or exported in various formats. It is also possible to change the type of graph, to filter results, to cross sort and to send a report of the assessment to students.

